

# WINTER

## Special Promotion

Sale Ends March 29, 2024

### MEGAPRO: PGS 2-3



### FLASHLIGHTS: PG 4



### KLEIN TOOLS: PG 5



### RIDGID TOOLS: PGS 6-7



### MILWAUKEE TOOLS: PGS 8-9



### WASHROOM: PGS 10-11



### FASTENER KITS: PG 12



### PIPE REPAIR & FITTINGS: PGS 13-15



### DRINKING FOUNTAIN: PGS 16-19



### FLUSH VALVE: PGS 20-21



### DOOR HARDWARE: PG 22



### GARBAGE DISPOSALS: PG 23



### T&S FAUCETS: PGS 24-25



### CHEMICALS & WIPES: PGS 26-27



### GLOVES & TRACTION: PG 28



# MEGAPRO

**#37696**



**\$37.95 ea**

## The Original

The most popular Megapro® driver! Loaded with 7 double end professional quality bits, this assortment provides the 14 most popular tips for driving screws. All bits are conveniently stored right in the handle! The shaft opening serves as a 1/4" hex driver.

**Replacement Bit Kit**  
(See Page 3)

**#39735**

**\$18.35 ea**

**#37697**



**\$48.40 ea**

## Tamperproof

This 15-in-1 is a must for all commercial and industrial tradesmen. The Tamperproof assortment includes the most popular security bits, such as Spanners, Hex Pins and Torx Pins. All bits are conveniently stored right in the handle! The shaft opening serves as a 1/4" hex driver.

**Replacement Bit Kit**  
(See Page 3)

**#39736**

**\$26.98 ea**

**#36599**



**\$56.85 ea**

## Tamperproof 2

This 15-in-1 driver is the same as #37697, but with different security bits for commercial and industrial tradesmen. The Tamperproof 2 assortment includes Tri-wing, Torq-Set, and TorxPlus bits. The shaft opening serves as a 1/4" hex driver.

**#37698**



**\$49.35 ea**

## ShaftLOK

Locking shaft eliminates the danger of bits falling out of the shaft when getting partially stuck in the fastener. 6" and 10" locking extensions get you into hard-to-reach places. This 15-in-1 driver holds 7 double end professional quality bits, including the most popular tips for driving screws. All bits are conveniently stored right in the handle! The shaft opening serves as a 1/4" hex driver.

**#39339**



**\$46.85 ea**

## Precision

This precision screwdriver is designed specifically for those working with (and on) electronics, technology, security, jewelry, and any other repairs in a "micro" environment. This screwdriver comes with 24 of the most popular precision bit tips – all conveniently stored in the Megapro Patented Retractable Bit Cartridge!

**#37702**



**\$59.85 ea**

## Ratcheting

This 13-in-1 ratcheting screwdriver delivers over 225 inch lbs of torque strength. Precision 28-tooth ratchet design with rubberized cushion grip makes driving faster and easier. Loaded with 6 double end professional quality bits including the most popular tips for driving screws. All bits are conveniently stored right in the handle! The shaft opening serves as a 1/4" hex driver.

**#37710**



**\$42.15 ea**

## HVAC

Perfect for HVAC installers, this driver is loaded with 6 double end bits including the Schrader Valve Stem bit, and the DoubleLok Phillips #2 Combo bit which can be used in any 1/4" quick change chuck. It also features a Square Awl Reamer for punching through sheet metal. All bits are conveniently stored right in the handle! The shaft opening serves as a 1/4" hex driver.



**MEGAPRO®**

## IMPACT NUTSETTERS

**#38123** **\$22.50 ea**



- Includes sizes 1/4", 5/16", 3/8", 7/16", and 1/2"
- Color coded for easy identification
- Made of durable machined S2 steel
- Black oxide finish protects against corrosion

**#39365** **\$24.36 ea**

- As above but with **metric sizes** 6mm, 7mm, 8mm, 10mm, and 12mm

**MEGAPRO®**

## SQUARE+PHILLIPS+TORX IMPACT 10PC BIT SET

**#38122** **\$19.50 ea**



- Includes sizes SQ1, SQ2, SQ3, PH1, PH2, PH3, PR2, T15, T20, AND T25.
- Color coded for easy identification
- Made of durable machined S2 steel
- Black oxide finish protects against corrosion

## 4 IN 1 POCKET SCREWDRIVER

**#37756** **\$6.62 ea**



The 4-in-1 Pocket Driver is a handy tool that features a double ended slot bit and a double ended Phillips bit. Perfect for a tool box, glove box, or even to clip onto your shirt, tool pouch, or tool belt.

## MEGAPRO® SHAFTLOK DRIVER KIT

**#37704** **\$52.41 ea**



Includes #37698 MegaPro ShaftLOK Driver, #37700 6-inch extension, and holster. The locking shaft eliminates the danger of bits falling out of the shaft when getting partially stuck in the fastener.

## LOCKING EXTENSIONS

Locks into ShaftLOK driver shaft, providing a slim profile into those hard-to-reach places. Clearance: .375" min.

**#37699** - 10"

**\$22.20 ea**

**#37700** - 6"

**\$17.85 ea**

## KIT CASE

**#37681**

**\$27.67 ea**



**MEGAPRO®**

Rugged plastic case has three compartments to store screwdrivers, bits, and accessories.

## MEGAPRO® SCREWDRIVER SET

**#38032** **\$135.50 ea**



*Four Great Tools in One Handy Kit!*

Includes Megapro Original Driver w/ bits, Tamperproof Driver w/ bits, HVAC Driver w/ bits, High Intensity Work Light, and durable plastic case.

## REPLACEMENT BIT PACK 7 ORIGINAL DOUBLE ENDED BITS

Includes Phillips 0-3, 1-2, Torx 10-15, 20-25, Square 0-3, 1-2, Flat 4-6. Used on the Original Driver #37696 (see page 2.)



**#39735**

**\$18.35 ea**

## REPLACEMENT BIT PACK 7 TAMPERPROOF DOUBLE ENDED BITS

Includes Hex Pin 1/8-9/64, 5/32-3/16, Spanner 6-8, 10-12, Torx Pin 10-15, 20-25, 27-30. Used on the Tamperproof Driver #37697 (see page 2.)



**#39736**

**\$26.98 ea**

# FLASHLIGHTS

## WORK LIGHT WITH LANTERN & HOLSTER

*Includes 4 AAA Batteries*

**#36995** **\$32.19 ea**



- Outstanding LED flashlight offers 250 lumens of intense white light
- COB lantern outputs 190 lumens.
- Body extends to reveal COB work light
- Length: 6-1/2" closed, 8-7/8" extended
- Convenient no-roll design
- Anodized aircraft grade aluminum
- Water and impact resistant
- Powerful magnetic base

## RECHARGEABLE HEADLAMP

**KLEIN TOOLS**

**#39175** (56064)

**\$42.50 ea**



- Rechargeable auto-off LED headlamp has 3 modes: Boost at 400 lumens for 4 hours, Spotlight at 200 lumens for 12 hours, and Floodlight at 100 lumens for 22 hours
- Pivoting mount allows up to a 64° lighting angle
- Automatically turns off after 3 minutes in bright light
- Adjustable silicone strap secures headlamp onto head, hard hat, or cap

## HIGH-INTENSITY WORK LIGHT

**#37680** **\$18.03 ea**

*Includes 3 AAA Batteries*



Produces a powerful floodlight effect to see your work! Quality push button on/off switch. Molded clip to stay in your pocket. Water-resistant superior design. Uses 3 AAA batteries (included) to drive 6 super bright white LEDs.

## MULTI-FUNCTION HEAD LAMP

**#38423** (56220) **\$28.64 ea**

*Includes 3 AAA Batteries*

**KLEIN TOOLS**



- LED light has 2 modes: Spotlight at 150 lumens for 6 hours, and Floodlight at 50 lumens for 10 hours
- 45-degree tilt allows for varied beam direction
- Adjustable silicone strap secures headlamp onto head, hard hat, or cap

## HI-BEAM RECHARGEABLE FLASHLIGHT

*A Super Bright, Wide-Beam Zoomable Flashlight with a Built-In USB Power Bank*

**#38624** **\$33.25 ea**



- Beam distance of more than 900ft
- 620 lumens at 100%
- Recharges with a USB cable (included)
- Run time at 100% is 2 hours
- Powerful magnet at grip end
- 6.875 in. long, weighs 5 oz.

## EXTENDABLE MAGNETIC INSPECTION TOOL & FLASHLIGHT

**#36194** **\$29.77 ea**

*Includes 1 AA Battery*



Extends from 8.25" to 24". The 360° rotating inspection mirror illuminates what you've lost or dropped. Magnetic heads help you retrieve the items you can't reach with your hands. Includes soft case.

## RECHARGEABLE FOCUS FLASHLIGHT WITH LASER

**KLEIN TOOLS**

**#39254** (56040) **\$42.95 ea**



- The rechargeable focus flashlight with class IIIA red laser pinpoints out of reach objects
- Strong magnetic end cap for hands-free use
- A 12-hour all day runtime on low of 125 lumens, and a 6-hour runtime on high with bright 350 lumens
- Low battery indicator - charge via USB cable (included)
- Removable pocket clip with an integrated lanyard hole



## ALL-IN-ONE PRECISION SCREWDRIVER SET WITH CASE

#39255 (32717)

\$31.98 ea

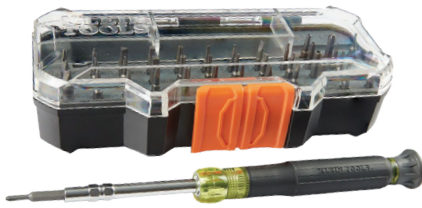

- Contains 39 bits for various applications, including repair of most Apple® products
- Powerful magnets inside barrel to better retain bits, as well as pick-up and hold fasteners
- Reversible barrel has standard and extended-reach ends

## 11-IN-1 IMPACT MULTI-BIT SCREWDRIVER/NUT DRIVER



#39936 (32500HD)

\$24.85 ea



- Includes impact rated 1/4", 5/16" and 3/8" power nut drivers, 1/2" standard nut driver, #1, #2 Phillips, 1/4" and 3/16" slotted, #1, #2 square recess, and T25 TORX®
- Interchangeable components for fast and easy switch outs
- Integrated magnetic bit holder also serves as a magnetic 1/4" power nut driver
- Color coded power nut drivers for easy size identification

## 10-IN-1 FOLDING POCKET SCREWDRIVER/NUT DRIVER

#39198 (32535)

\$32.87 ea



Contains 5/16" and 1/4" nut drivers, #1 and #2 Phillips, 1/4" and 3/16" slotted, T10 and T15 TORX, and #1 and #2 square-recess bits

## 27-IN-1 TAMPERPROOF MULTI-BIT SCREWDRIVER

#39256 (32307)

\$27.56 ea



- On-board storage of 26 different tamperproof bits and a 1/4" nut driver
- Includes the following tamper-proof bits: Torx®, TORQ-SET®, Hex, and Spanner

## 11-IN-1 MAGNETIC SCREWDRIVER NUT DRIVER

#39232 (32500MAG)

\$22.25 ea



- Integrated screwdriver / nut driver magnetic barrel holds 8 popular tips and converts to 3 nut driver sizes
- Includes tips: 3/8", 5/16" and 1/4" nut drivers, #1 and #2 Phillips, 1/4" and 3/16" slotted, T10 and T15 TORX®, and #1 and #2 square recess

## BATTERIES ENERGIZER ALKALINE



Part #	Size	Volts	Price
#32737	AA	1.5	55¢ ea
#32738	AAA	1.5	55¢ ea
#32739	C	1.5	\$1.12 ea
#32740	D	1.5	\$1.66 ea
#32741	9V	9.0	\$3.15 ea

## LITHIUM BATTERIES

Part #	Volts	Price
#32906 (223)	6.0	\$18.50 ea
#SP8229 (123)	3.0	\$20.17 pk
#38106 (AAA)	1.5	\$5.58 pk

Dozens of other types in stock! Call for assistance.

## POCKET BATTERY TESTER

#38188

\$13.46 ea



Checks the strength of AA, AAA, C, D, 9V, and 1.5V button cell batteries. Movable contact arm adjusts to fit different battery sizes.

# RIDGID TOOLS

## TRIDENT CABLE DECOUPLER

**#38969** **\$32.95 ea**



**RIDGID**

- Faster cable separation than traditional pin key
- Easily identifiable
- Aluminum provides great strength to weight ratio
- Accommodates 5/8", 7/8", and 1-1/4" sectional cables

### Disconnecting Using Trident Decoupler

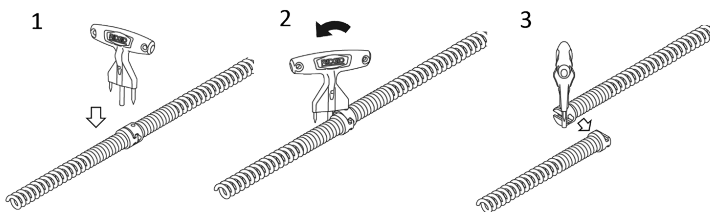

1. Fully insert decoupler (tapered end) to depress the plunger pin.
2. Rotate decoupler to contact other coupling.
3. Continue rotating decoupler to slide couplings apart.

## SNAKE COUPLING KEYPINS

**RIDGID**



**For 3/8" and 5/8" Cable**

**#35850** **\$7.25 ea**

**For 1/2" Cable**

**#35458** **\$7.25 ea**

### Disconnecting Using Pin Key

1. Fully insert pin key (rotate if needed) to depress the plunger pin
2. Slide coupler apart

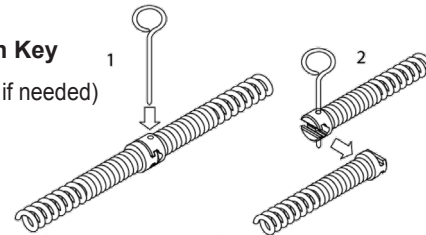

**RIDGID**

## SNAKE MITT

*Protects hands when working with cables*



**#34587**

Left Hand

**\$47.50 ea**

**#34588**

Right Hand

**\$47.50 ea**

## For Sectional Machines

## RIDGID CABLES

	PART#	MODEL	LENGTH	SIZE/TYPE	TYPICAL APPLICATION	CHARACTERISTICS	MACHINES	PRICE
	<b>#34889</b>	C-7	7-1/2'	5/8"	2" and 3" floor drains.	Tight wind cable providing good rigidity in a hollow core cable. Not for tree roots.	K-50, K-60SP	<b>\$62.77 ea</b>
	<b>#34475</b>	C-8	7-1/2'	5/8"	Drain lines 1-1/4" to 2"-ideal for proper cleaning of small lines.	Open wind cable that is more flexible than C-7. Open wind acts as an auger to thoroughly remove blockage in small lines.	K-50, K-60SP	<b>\$46.98 ea</b>

## For Drain Guns, Sink Drums And Small Line Sectional Machines

\* I.C. "Inner Core" Flexible Cable

	PART#	MODEL	LENGTH	SIZE/TYPE	TYPICAL APPLICATION	CHARACTERISTICS	MACHINES	PRICE
	<b>#35071</b>	C-2	25'	5/16" Drop Head	Drain lines 3/4" to 1-1/2". Drop head leads into down drain pipes, especially good for back-to-back mounted fixtures and severe bends.	Hollow core cables that provide flexibility for severe bends and "P"-traps.	K-25/K-26 (25' only) K-39 K-40 K-50*	<b>\$94.60 ea</b>
	<b>#36142</b>	C-11	15'	1-1/4"	Drain lines 3" to 8". Good for all around work. Easily negotiates 4" traps.	Standard all-purpose open wind with 3/8" pitch. Flexible, yet rigid enough to do fast, tough root cutting.	K-1500A/B/ & SP	<b>\$169.03 ea</b>
	<b>#36138</b>	C-23ic	35'	5/16" Inner Core w/ Drop Head	Drain lines 1-1/4" to 2". Drop head leads into down drain pipes, especially good for back-to-back mounted fixtures and severe bends.	Inner core cables that provide good flexibility while delivering more cleaning power to cable end. Resists kinking.	K-25/K-26 (25' only) K-39 K-40 K-3800 K-50*	<b>\$128.52 ea</b>
	<b>#35069</b>	C-5	35'	3/8" w/ Bulb Auger	Drain lines 1-1/4" to 2-1/2" Kitchen sinks, lavatory sinks, slop sinks and laundry lines.	Flexible cables most commonly used after traps have been removed. Resists kinking.	K-39 K-40 K-50*	<b>\$120.05 ea</b>



## QUICK ACTING TUBING CUTTER

**RIDGID**

**#34253** (151) 1/4" to 1-5/8" OD

**\$71.67 ea**

**#35407** (152) 1/4" to 2-5/8" OD

**\$119.10 ea**

**#35408** (153) 1-1/4" to 3-1/2" OD

**\$71.67 ea**



## TAILPIECE EXTENSION CUTTER

**RIDGID**

*Clean, Automatic  
Deburring*

**#36189** **\$35.55 ea**



Can be used on Polyethylene (PE), Polypropylene (PP), and Thin-Walled PVC disposer kits, tailpieces and wall tubes of two standard sizes: 1-1/4" and 1-1/2" OD.

## TUBING CUTTER

**RIDGID**

**#34668** (150)  
1/8" thru 1-1/8" OD

**\$43.70 ea**



Features an enclosed feed screw to eliminate clogging and jamming, grooved rollers for close to flare cuts, and a fold away reamer. Spare cutter wheel in the handle. Cuts copper, brass, & aluminum tubing, and thin wall conduit.

## TELESCOPING BASIN WRENCH WITH BUILT-IN LED LIGHT

**RIDGID**

**#38024** (46753)  
Basin Wrench

**\$79.76 ea**

**#38730** (48253)  
3V Battery for Wrench

**\$3.25 ea**



- Water-resistant LED has an auto-shut off
- Pivoting T-handle can be removed for access into tighter spaces
- 3/8" square drive connection allows for the use of a ratchet or breaker bar for additional leverage and torque
- Telescopes from 10" to 17"

## MINIATURE TUBING CUTTER

**RIDGID**

**#03011** (103)  
1/8" - 5/8" OD

**\$22.04 ea**

**#34251** (104)  
3/16" - 15/16" OD

**\$28.30 ea**

**#34425** (101)  
1/4" - 1-1/8" OD

**\$37.86 ea**



Specifically designed for use in extra close quarters on small size hard and soft copper, aluminum, brass and plastic tubing.

## OFFSET NON-MARKING WRENCH

**RIDGID**

*An Equiparts  
Favorite!*

**#08070** **\$57.71 ea**



## EZ CHANGE FAUCET TOOL

**RIDGID**

*The One Tool for Common  
Faucet Installations and Sink Strainers*

**#38631** **\$34.87 ea**



- Unique cubed insert provides a variety of common nut sizes.
- Ideal for most common 2, 3, 4, and 6 tab mounting nuts.
- Wrench for tight shut-off valves.
- Retainer for 3 or 4 slot strainer baskets.
- 5/8" deep welled socket for many single hole mountings
- Short body for clearance in tight spaces.

## TUBING CUTTER REPLACEMENT WHEELS



**#34586** (E-3469)  
**\$10.75 ea**

For Cutting  
Aluminum and Copper

Fits Cutter Models No.101,103, 104, 118, 151, 152, 153, 205

# MILWAUKEE TOOLS

## M18™ TWO-GALLON WET/DRY VACUUM

*Powerful Suction for Wet & Dry Applications*



**#39506**

**\$142.70 ea**

- 2 Gallon Capacity
- 30+ minutes of clean-up on an M18™ RedLithium™ High Demand™ 9.0 Battery Pack
- 32" of Water Lift and 45 CFM
- Attachments Included: 6 Foot Flexible Hose, Crevice Tool, and Utility Nozzle, with on-board storage for all
- HEPA Filter Included
- Stackable Tool Box Design

## MILWAUKEE BATTERY PACKS

**#39697**

M18™ RedLithium™ High Output CP3.0 Battery Pack

**\$142.70 ea**



**#39648**

M18™ RedLithium™ XC5.0 Extended Capacity Battery Pack

**\$178.24 ea**



**#SP18904**

M12™ RedLithium™ 3.0 Compact Battery Pack

**\$75.95 ea**



**#SP16212**

M12™ RedLithium™ XC6.0 Battery Pack

**\$128.38 ea**



## M12™ FUEL INSTALLATION DRILL/DRIVER KIT

*Unrivalled Access and Maneuverability in Hard-to-Reach Places!*



Use your smart phone camera to scan this QR code and watch a short demo video of this driver!

### Includes:

- (1) M12 FUEL™ Installation Drill/Driver
- (2) M12™ REDLITHIUM™ CP2.0 Battery
- (1) M12™ Lithium-ion Battery Charger
- (1) Right Angle Attachment
- (1) Offset Attachment
- (1) 3/8" Metal Chuck Attachment
- (1) 1/4" Hex Attachment
- (1) Compartmentalized Contractor Bag
- (1) Belt Clip

**#39853**

**\$228.99 ea**

## M18™ SIX PACK SEQUENTIAL BATTERY CHARGER



- Charges up to six batteries sequentially
- Convenient carrying handle
- Pass through plug
- Compact size

**#39671**

**\$143.51 ea**

### Features:

- Offset Attachment provides ultimate access to tight corners and will not damage or mar finished materials when fastening
- Right Angle Attachment provides efficient fastening and/or drilling at 90 degrees for unrivalled access in tight spaces
- All Metal 3/8" Chuck and 1/4" Hex attachments add to user productivity by delivering the versatility to efficiently perform most drilling & fastening applications
- 5.12" wide and only 2.0 lbs with battery attached
- POWERSTATE™ Brushless Motor delivers 300 in-lbs of max torque
- Attachments connect in 16 different positions for access at almost every angle
- Compatible with all M12™ batteries



## BATTERY MOUNTS FOR MILWAUKEE

*Store and Organize Your Batteries  
So You Can Always Find Them Easily!*

- Install these mounts in your workshop, toolboxes, tool trailers, under shelves, or in your work vehicles
- Batteries are locked in and secured with a click
- Can be mounted in many different directions allowing maximum use of space
- Made with strong injection molded ABS plastic
- Keep your workshop and work vehicles organized
- Never lose your batteries again!



**#39943**  
For M12 Batteries  
Set of 6 - Black

**\$22.94 pk**



**#39944**  
For M18 Batteries  
Set of 6 - Red

**\$22.94 pk**

## TOOL MOUNTS FOR MILWAUKEE

*Store and Organize Your Tools  
So You Can Always Find Them Easily!*

- The perfect solution for storing and organizing your cordless power tools
- Very convenient to assemble and use. Tools can be easily mounted by sliding the tool onto the holder
- Specially designed to be used in workshops, under shelves, or fitted to a truck panel's toolbox. It will keep your cordless tools together and organized to avoid losing track of them
- These mounts are injection molded through ABS plastic, and have countersunk screw holes for firm mounting



**#39945**  
For M12 Tools  
Set of 3 - Black

**\$22.94 pk**

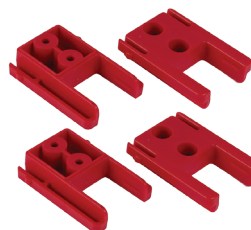

**#39946**  
For M18 Tools  
Set of 4 - Red

**\$22.94 pk**

## 7 PIECE SHOCKWAVE™ CARBIDE HAMMER DRILL BIT KIT



**#39718** **\$28.40 ea**

Includes the Following  
SHOCKWAVE™  
Carbide Hammer Drill Bits:

- (1) 5/32" x 4" x 6"
- (2) 3/16" x 4" x 6"
- (2) 1/4" x 4" x 6"
- (1) 5/16" x 4" x 6"
- (1) 3/8" x 4" x 6"

## M18™ PROPANE HEATER 70,000 BTU FORCED AIR



- All day max heat
- Safe and reliable unit
- Auto shut-off after battery discharge
- On board hose storage for fast setup
- Brushless motor delivers longer life

**#39950**

**\$247.69 ea**

# WASHROOM

## ANTI-SPLASH URINAL SCREENS

Heavy Duty - Lasts up to 60 days

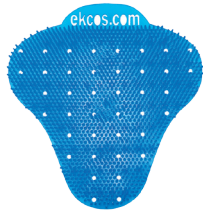

PART#	COLOR	SCENT
#79957	Green	Apple
#79958	Blue	Fresh
#79959	Red	Melon
#79960	Purple	Lavender

*Your Choice!*  
2 per pack

**\$9.89 pk**

Power Screen - Lasts up to 30 days

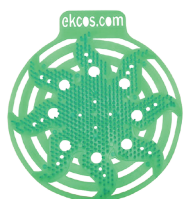

PART#	COLOR	SCENT
#79961	Green	Apple
#79962	Blue	Fresh
#79963	Red	Melon
#79964	Purple	Lavender

*Your Choice!*  
2 per pack

**\$6.50 pk**

## MAGNETIC DOOR BARRIERS

• Made with durable, rot-resistant nylon

• Fits standard 36" metal door frame



**#38554**  
Orange

**\$25.75 ea**



**#38558**  
Yellow

**\$25.75 ea**



**#38560**  
Red

**\$25.75 ea**



**#38559**  
Yellow  
Fits 51" door frame

**\$25.75 ea**

## "CLOSED FOR MAINTENANCE" SIGN



**#37909**  
18" x 12"

**\$39.98 ea**

The tension rod secures the sign in doorways up to 60" wide. Rubber grips on the ends of the rods help hold it in place.

## SURFACE MOUNTED SOAP DISPENSERS

BOBRICK

- Stainless Steel
- 40 fl. oz. Fill Capacity
- Satin Finish
- Uses Liquid Soaps



**#11104**

**\$89.60 ea**



**#15606**

**\$49.85 ea**



**#15627**

**\$49.85 ea**

## HURRICONE FLOOR DRYER



*Dry Your Wet Floors  
in Just a Few Minutes!*

**#38004**

**\$425.00 ea**

- Generates a continuous flow of air in 360 degrees and up to 15 feet in diameter!
- Decreases floor drying time up to 90%
- Creates a safer environment for your employees and patrons
- Cordless operation. Runs up to eight hours on a rechargeable battery pack

## TOILET TISSUE HOLDERS

BOBRICK



**#11103**  
Multi-Roll SS  
Paper Dispenser  
Surface Mount  
Flush Lock

**\$153.50 ea**



**#01302**  
"Deluxe" Double Holder

**\$34.51 ea**



**#01303**  
Double Holder

**\$21.50 ea**



**#01295**  
"Deluxe" Paper Holder

**\$26.08 ea**



**#01294**  
Single Tissue Holder

**\$9.89 ea**



BOBRICK

## TAMPON/NAPKIN DISPENSER

**#603848**
**\$695.60 ea**

- 25¢ push button operation
- Holds 30 tampons and 20 napkins
- Separately keyed coin box lock
- Satin finish stainless steel cabinet
- Returned coin or wrong coin by-pass mechanism drop into product tray
- 11-7/8" W x 25-7/8" H

BOBRICK

## BOBRICK MANUAL LIQUID SOAP DISPENSERS

Corrosion-resistant valves. Fills from top for ease of maintenance. Free turning spouts are vandal resistant. Spout and stem are stainless steel with bright finish. Escutcheon is chrome-plated ABS.



### Lav Mounted Soap Dispenser

**#01599** (B-822)

34 fl. oz. Capacity

4" Spout

**\$59.98 ea**

### Soap Pump Assembly

**#55458** (822-619)

4" Spout

**\$49.26 ea**

### Lav Mounted Soap Dispenser

**#11188** (B-8226)

34 fl. oz. Capacity

6" Spout

**\$69.50 ea**

### Soap Pump Assembly

**#14247** (8226-619)

6" Spout

**\$59.64 ea**

BOBRICK

## NAPKIN DISPOSAL

**#11088**

Stainless Steel

**\$43.32 ea**
**#11317**

Grey ABS Plastic

**\$38.95 ea**
**#16094**

Liner Bags (500pc.)

**\$89.50 ea**

BOBRICK

## TOILET SEAT COVER DISPENSER

**#11173**

Stainless Steel

**\$51.30 ea**
**#SP2053**

Grey ABS Plastic

**\$31.20 ea**

BOBRICK

## SURFACE MOUNTED PAPER TOWEL DISPENSER

**#14195**
**\$79.90 ea**

- Stainless Steel
- Satin Finish
- Multi-Fold or C-fold

## HANDS-FREE PAPER TOWEL DISPENSER

PALMER  
FIXTURE

**#15678**
**\$139.95 ea**

- Dispenses most non-perforated towels up to 8" in diameter and 8" wide.
- Autocut mechanism provides user with an 11" sheet.
- Requires four D batteries (part **#32740**)

## CENTER PULL-DOWN PAPER TOWEL DISPENSER

**#16873**
**\$49.98 ea**

- Simple, cost effective, & reliable
- Dispenses one towel at a time
- No batteries
- No electronics
- No moving parts
- No cutting blade

# FASTENER KITS

## COMPLETE NUTSERT TOOL KIT

**#28200**

**\$205.60 ea**

*Includes Sizes:*

- 6-32
- 8-32
- 10-24
- 1/4-20
- 5/16-18



*Tool and Conversion Tips Included*

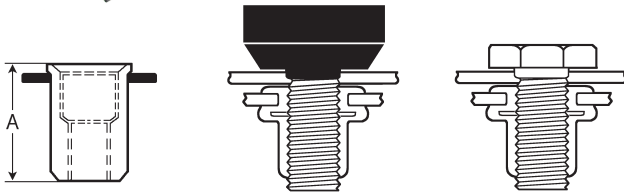

### HOW IT WORKS

The nutsert, held securely by the tool, is placed into the prepared hole. Upon the tool's actuation, the threaded portion is pulled until the fastener's wall collapses radially outward, clinching it tight against the sheet. The tool is withdrawn, leaving the nutsert ready to receive a bolt or screw. This complete operation takes only a few seconds and can be performed by anyone.

## SELF-DRILLING HEX SCREW ASSORTMENT

**#28106** **\$120.61 ea**

*Includes:*

- |    |            |    |                 |
|----|------------|----|-----------------|
| 25 | 12 x 1-1/2 | 50 | 8 x 1-1/4       |
| 25 | 12 x 1-1/4 | 50 | 8 x 1           |
| 50 | 10 x 1-1/4 | 50 | 8 x 3/4         |
| 50 | 10 x 1     | 50 | 8 x 1/2         |
| 50 | 10 x 3/4   | 1  | 5/16 Mag. Chuck |
| 50 | 10 x 1/2   | 1  | 1/4 Mag. Chuck  |
| 50 | 8 x 1-1/2  |    |                 |



## COMBO PHILLIPS & SLOTTED PAN HEAD SHEET METAL SCREW ASSORTMENT

**#22776** **\$133.04 ea**

- 24 variety assortment
- Approximately 1200 pieces
- Heavy duty locking metal drawer



## PHILLIPS PIN-PAN HEAD STAINLESS STEEL MACHINE SCREW KIT

**#70962** **\$350.60 ea**

- Pin head
- 20 variety assortment
- Approximately 500 pieces
- Heavy duty locking metal box
- Includes pin head bits



## ADJUST-A-DRAWER CASES

*Includes 9 removable dividers*

**#27977**

**Standard**

**\$27.50 ea**

13-5/16" W x 9" D x 2" H

**#27978**

**Large**

**\$46.50 ea**

18" W x 12" D x 3" H



## 20 COMPARTMENT CASES

**#27974**

**Standard**

**\$27.50 ea**

13-5/16" W x 9" D x 2" H

**#71201**

**Large**

**\$46.50 ea**

18" W x 12" D x 3" H



## STANDARD SLIDE RACK

*Holds 4 Drawers*

**#27972** **\$135.60 ea**

- Width 15-1/4"
- Depth 11-3/4"
- Height 11-1/4"



## LARGE SLIDE RACK

*Holds 4 Drawers*

**#27970** **\$179.50 ea**

- Width 20"
- Depth 15-3/4"
- Height 15"





## NO SOLDER EQUIPRO REPAIR BALL VALVE

dahl

**Compression  
Type**



**#59741** For 1/2" copper

**\$37.05 ea**

**#59743** For 3/4" copper

**\$59.08 ea**

## TRY THIS! EPOXY PUTTY - 4 OZ.



**#79072**

**\$17.27 ea**

Hardens in 5 minutes, even underwater. Contains metal.  
Forms stone hard bond. Can be filed, sawed, & tapped.

**Easy To Use! One Step! Has 1001 Uses!**

## PIPE WRAP TAPE



**#79045** 1" x 10'

**\$7.85 ea**

This self-bonding super tape forms a strong, durable seal, even under water. Withstands extreme hot or cold.

## FREEZE FIX

**Easy To Use!**

**The ideal method to  
repair pipes damaged by freezing!**

Can be applied to all types of pipes, even under water!



Part#	Repairs Pipe	Price
<b>#81319</b>	1/4" - 1/2"	<b>\$14.65 ea</b>
<b>#81320</b>	3/4"	<b>\$14.65 ea</b>
<b>#05397</b>	3/4" - 1-1/2"	<b>\$14.65 ea</b>
<b>#81321</b>	2" - 2-1/2"	<b>\$29.93 ea</b>
<b>#81322</b>	3"	<b>\$29.93 ea</b>
<b>#81323</b>	4" - 5"	<b>\$29.93 ea</b>

## INSTA-CLAMP™ PLUMBER'S KIT

**Be prepared !**



**#81990** **\$219.60 ea**

- Repairs couplings, 45s, 90s, tees, and joints
- Includes one size of each Insta-Clamp™ from 1/2" to 2"
- Includes 12" Canvas Tool Bag
- Includes 24" OD Tape Measure

## INDIVIDUAL INSTA-CLAMPS™

**The Best Pipe Repair Clamp On The Market!**



Part #	Copper Pipe Size	OD	Price
<b>#81974</b>	1/2"	5/8"	<b>\$32.69 ea</b>
<b>#81975</b>	3/4"	7/8"	<b>\$34.07 ea</b>
<b>#81976</b>	1"	1-1/8"	<b>\$34.07 ea</b>
<b>#81977</b>	1-1/4"	1-3/8"	<b>\$34.60 ea</b>
<b>#81978</b>	1-1/2"	1-5/8"	<b>\$37.42 ea</b>
<b>#81979</b>	2"	2-1/8"	<b>\$42.16 ea</b>
<b>#81980</b>	2-1/2"	2-5/8"	<b>\$45.89 ea</b>
<b>#81981</b>	3"	3-1/8"	<b>\$70.53 ea</b>
<b>#81982</b>	4"	4-1/8"	<b>\$75.42 ea</b>

## EMERGENCY PIPE REPAIR CLAMP

**The quick, easy, & professional  
way to temporarily repair a leaky pipe!**

**Use on Copper, CPVC, or PEX piping**



**#38012** (80007) **\$47.39 ea**

For 1/2" Copper Pipe (5/8 OD)



**#38013** (80012) **\$50.66 ea**

For 3/4" Copper Pipe (7/8 OD)

## MINIATURE TUBE CUTTER

**RIDGID**



**#03011** (103)

1/8" - 5/8" OD

**\$22.04 ea**

**#34251** (104)

3/16" - 15/16" OD

**\$28.30 ea**

**#34425** (101)

1/4" - 1-1/8" OD

**\$37.86 ea**

## CLOSE QUARTER COPPER TUBING CUTTER

**General Wire Spring Company**



**#35174**

For 1/2" Copper

**\$29.24 ea**

**#35177**

For 3/4" Copper

**\$31.95 ea**

**#37234**

For 1" Copper

**\$33.50 ea**

# FITTINGS

## PUSH FITTINGS

*Lead Free*

### STRAIGHT COUPLING



#58600	1/2" x 1/2"
#58601	3/4" x 3/4"
#58602	1" x 1"

\$6.56 ea
\$8.93 ea
\$17.67 ea

### TEE



#58611	1/2" x 1/2" x 1/2"
#58612	3/4" x 3/4" x 3/4"
#58614	3/4" x 3/4" x 1/2"
#58617	3/4" x 1/2" x 1/2"
#58613	1" x 1" x 1"
#58615	1" x 1" x 3/4"

\$11.81 ea
\$17.20 ea
\$16.79 ea
\$15.80 ea
\$34.34 ea
\$28.45 ea

### ELBOW



#58603	1/2" x 1/2"
#58604	3/4" x 3/4"
#58606	3/4" x 1/2"
#58605	1" x 1"

\$8.71 ea
\$12.08 ea
\$17.49 ea
\$21.71 ea

### REDUCING



#58609	3/4" x 1/2"
#58610	1" x 3/4"

\$8.32 ea
\$13.95 ea

### STRAIGHT CONNECTOR



#58619	1/2" x 1/2" FNPT
#58620	3/4" x 3/4" FNPT
#58624	3/4" x 3/4" MNPT
#58623	1/2" x 1/2" MNPT

\$6.64 ea
\$9.24 ea
\$8.43 ea
\$6.47 ea

### END STOP



#58630	1/2"
#58631	3/4"
#58632	1"

\$4.75 ea
\$7.19 ea
\$9.66 ea

### DISCONNECTING CLIP FOR PUSH FITTINGS



#58633	1/2"
#58634	3/4"
#58635	1"

\$1.10 ea
\$1.45 ea
\$1.74 ea

### PUSH BALL VALVE



#81060	1/2"
#81061	3/4"
#81062	1"

\$16.32 ea
\$23.03 ea
\$44.92 ea

### REPAIR KIT



#60320	Contains 40 pieces of 1/2" and 3/4" fittings
--------	--

\$388.26 ea
-------------

## LEAD FREE COPPER FITTINGS

*Other Sizes & Types In Stock!*

### COUPLING WITH STOP



NOMINAL SIZE	ACTUAL O.D. SIZE	PART #	PRICE
1/2"	5/8"	#44548	\$0.57 ea
3/4"	7/8"	#44550	\$1.14 ea
1"	1-1/8"	#44552	\$2.29 ea
1-1/2"	1-5/8"	#44554	\$5.32 ea

### TEE



NOMINAL SIZE	ACTUAL O.D. SIZE	PART #	PRICE
1/2"	5/8"	#44657	\$1.28 ea
3/4"	7/8"	#44659	\$3.08 ea
1"	1-1/8"	#44660	\$8.84 ea
1-1/2"	1-5/8"	#44662	\$20.04 ea

### COUPLING WITHOUT STOP



NOMINAL SIZE	ACTUAL O.D. SIZE	PART #	PRICE
1/2"	5/8"	#44539	\$0.75 ea
3/4"	7/8"	#44541	\$1.56 ea
1"	1-1/8"	#44542	\$3.28 ea
1-1/2"	1-5/8"	#44544	\$6.69 ea

### 90° ELBOW



NOMINAL SIZE	ACTUAL O.D. SIZE	PART #	PRICE
1/2"	5/8"	#44579	\$0.75 ea
3/4"	7/8"	#44581	\$1.67 ea
1"	1-1/8"	#44582	\$4.11 ea
1-1/2"	1-5/8"	#44584	\$9.00 ea

### MALE ADAPTER



NOMINAL SIZE	ACTUAL O.D. SIZE x IPS	PART #	PRICE
1/2"	5/8" x 1/2"	#44635	\$1.56 ea
3/4"	7/8" x 3/4"	#44636	\$3.02 ea
1"	1-1/8" x 1"	#44637	\$6.78 ea
1-1/2"	1-5/8" x 1-1/2"	#44639	\$11.53 ea

### 45° ELBOW



NOMINAL SIZE	ACTUAL O.D. SIZE	PART #	PRICE
1/2"	5/8"	#44561	\$1.36 ea
3/4"	7/8"	#44563	\$2.40 ea
1"	1-1/8"	#44564	\$6.03 ea
1-1/2"	1-5/8"	#44566	\$9.83 ea

### REGULAR FEMALE ADAPTER



NOMINAL SIZE	ACTUAL O.D. SIZE x IPS	PART #	PRICE
1/2"	5/8" x 1/2"	#44628	\$2.49 ea
3/4"	7/8" x 3/4"	#44629	\$3.41 ea
1"	1-1/8" x 1"	#44630	\$7.30 ea
1-1/2"	1-5/8" x 1-1/2"	#44632	\$18.04 ea

### UNION



NOMINAL SIZE	ACTUAL O.D. SIZE	PART #	PRICE
1/2"	5/8"	#44786	\$13.40 ea
3/4"	7/8"	#44787	\$16.83 ea
1"	1-1/8"	#55759	\$26.31 ea
1-1/2"	1-5/8"	#44725	\$69.54 ea



# FITTINGS

15

## #87752











*For Use with Press Tools*



*36 Piece Kit Supplied in a Heavy Duty Locking Steel Case.*

*Many Other Sizes in Stock!*

**\$234.73**

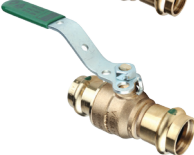

	Part#	Description	Price
	#45352	1/2 Coupling	\$2.48 ea
	#45376	3/4 Coupling	\$3.77 ea
	#81570	1/2 x 1/2 FNPT	\$4.07 ea
	#81699	1/2 x 1/2 MNPT	\$3.26 ea
	#45191	1/2 x 1/2 Elbow	\$2.76 ea
	#SP5274	3/4 x 3/4 Elbow	\$4.63 ea
	#80113	1/2 Tee	\$4.22 ea
	#81440	3/4 Tee	\$7.38 ea
	#80119	1/2 Cap	\$5.29 ea
	#80117	3/4 x 3/4 FNPT	\$6.33 ea
	#81566	3/4 x 3/4 MNPT	\$5.86 ea

	Part#	Description	Price
	#81368	3/4 Cap	\$9.08 ea
	#81374	1/2 Ball Valve	\$15.37 ea
	#81375	3/4 Ball Valve	\$21.33 ea

### BATTERY PRESS TOOL KIT

**RIDGID**



**#36867**

With ProPress Jaws  
1/2" - 2"

**\$4296.00 ea**

### M18™ FORCE LOGIC PRESS TOOL WITH ONE-KEY™

**Milwaukee**



**#39647**

With CTS Jaws  
1/2" - 2"

**\$4140.54 ea**

Includes Press Tool, M18 battery, M18 and M12 multi-voltage charger, carrying case, and jaw sizes 1/2", 3/4", 1", 1-1/4", 1-1/2", and 2".

# ELKAY DRINKING FOUNTAIN REPAIR

## #03557 (EZS8L) ELKAY ADA WATERCOOLER PARTS BREAKDOWN

*Items in Orange are the Most Commonly Replaced*

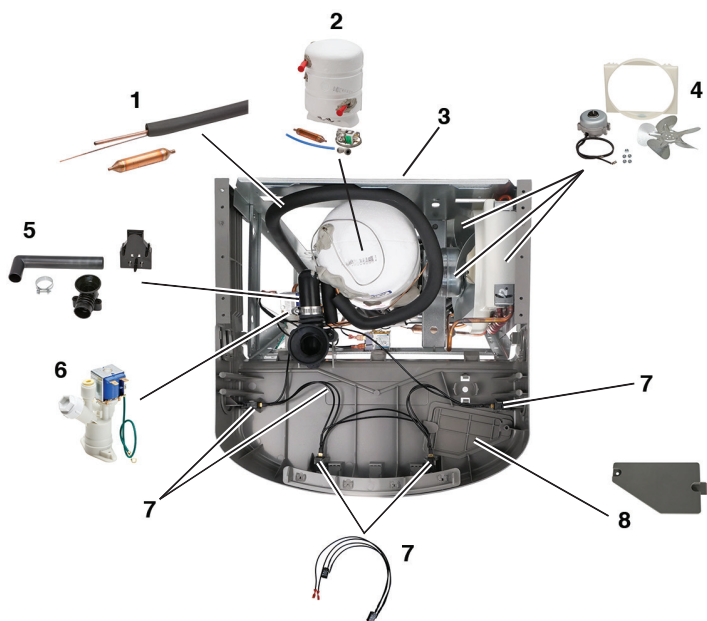

- |     |               |  |                    |
|-----|---------------|--|--------------------|
| 1.  | <b>#12804</b> | Heat Exchanger                           | <b>\$60.39 ea</b>  |
| 2.  | <b>#05908</b> | Evaporator Replacement Kit               | <b>\$236.38 ea</b> |
| 3.  | <b>#46862</b> | Hanger Bracket                           | <b>\$14.19 ea</b>  |
| 4.  | <b>#87848</b> | Water Cooler Fan Motor Kit               | <b>\$120.38 ea</b> |
| 5.  | <b>#83574</b> | Fountain Drain Kit                       | <b>\$43.74 ea</b>  |
| 6.  | <b>#84663</b> | Solenoid Valve Regulator Assembly        | <b>\$115.76 ea</b> |
| 7.  | <b>#83688</b> | Front & Side Push Button Wiring Harness  | <b>\$64.79 ea</b>  |
| 8.  | <b>#86362</b> | Access Panel                             | <b>\$3.55 ea</b>   |
| 9.  | <b>#87083</b> | Front & Side Drinking Fountain Push Bars | <b>\$52.34 ea</b>  |
| 10. | <b>#12806</b> | Front Pushbar Only (2 Pack)              | <b>\$34.68 ea</b>  |
| 11. | <b>#05793</b> | Flex Bubbler Assembly                    | <b>\$45.67 ea</b>  |
|     | <b>#84021</b> | Vandal Resistant Bubbler Assembly        | <b>\$133.49 ea</b> |
| 12. | <b>#66607</b> | Stainless Steel Fountain Basin           | <b>\$140.09 ea</b> |
| 13. | <b>#66933</b> | Cold Control / Thermostat Kit            | <b>\$29.87 ea</b>  |
| 14. | <b>#66113</b> | Condenser Kit                            | <b>\$85.74 ea</b>  |
| 15. | <b>#81764</b> | 5/16" x 1/4" Elbow                       | <b>\$2.77 ea</b>   |
| 16. | <b>#12800</b> | Drier                                    | <b>\$15.63 ea</b>  |
| 17. | <b>#89482</b> | Fountain Hardware Kit                    | <b>\$11.76 ea</b>  |
| 18. | <b>#12802</b> | Internal Wiring Kit                      | <b>\$19.89 ea</b>  |
| 19. | <b>#67753</b> | Overload & Relay                         | <b>\$47.37 ea</b>  |
| 20. | <b>#87641</b> | Compressor Service Pack                  | <b>\$334.85 ea</b> |
| 21. | <b>#12803</b> | Compressor Mounting Hardware             | <b>\$19.89 ea</b>  |

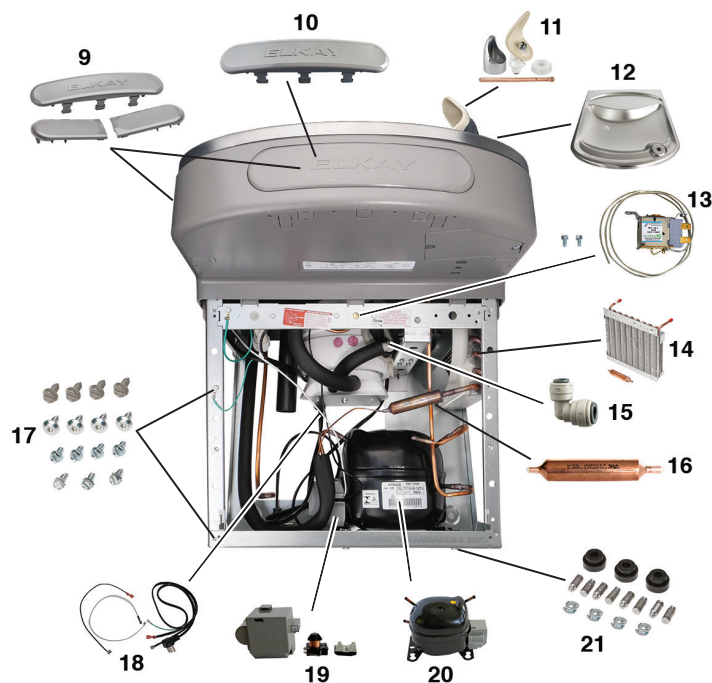

### #03557 (EZS8L) COMPLETE UNIT



**\$599.99 ea**

- 8.0 GPH
- Non-Filtered
- ADA Compliant
- Wall Mount
- Flexi-Guard Safety Bubbler with Antimicrobial Mouth Guard
- Gray Granite Finish



# OASIS DRINKING FOUNTAIN REPAIR

## #03530 (PG8AC) OASIS ADA VERSACOOLER II PARTS BREAKDOWN

*Items in Orange are the Most Commonly Replaced*

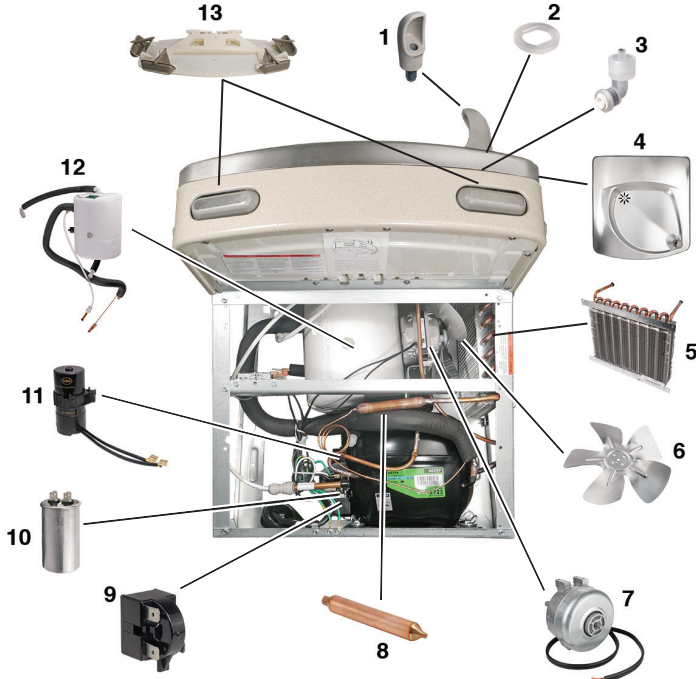

- |                     |                                    |                    |
|---------------------|------------------------------------|--------------------|
| 1. <b>#88434</b>    | Antimicrobial Flexible Bubbler     | <b>\$89.03 ea</b>  |
| 2. <b>#56239</b>    | Fountain Washer                    | <b>\$3.87 ea</b>   |
| 3. <b>#85862</b>    | Bubbler Nut w/ JG                  | <b>\$7.35 ea</b>   |
| 4. <b>#47014KIT</b> | New Style Fountain Basin S.S.      | <b>\$72.35 ea</b>  |
| 5. <b>#85828</b>    | Fountain Condenser                 | <b>\$62.13 ea</b>  |
| 6. <b>#05677</b>    | Fan Blade                          | <b>\$10.62 ea</b>  |
| 7. <b>#88190</b>    | Water Cooler Fan Motor             | <b>\$97.96 ea</b>  |
| 8. <b>#SP7543</b>   | Drier without Process Port         | <b>\$6.97 ea</b>   |
| 9. <b>#84683</b>    | Fountain Relay                     | <b>\$23.66 ea</b>  |
| 10. <b>#84684</b>   | Run Capacitor                      | <b>\$32.53 ea</b>  |
| 11. <b>#57496</b>   | Cooler Capacitor                   | <b>\$39.43 ea</b>  |
| 12. <b>#05914</b>   | Insulated Cooling Tank             | <b>\$321.78 ea</b> |
| 13. <b>#83693</b>   | Fountain Activation Assembly       | <b>\$45.78 ea</b>  |
| 14. <b>#85210</b>   | Union Elbow Fitting                | <b>\$7.54 ea</b>   |
| 15. <b>#SP10160</b> | Cartridge Holder                   | <b>\$5.15 ea</b>   |
| 16. <b>#57997</b>   | Fountain Cartridge                 | <b>\$31.25 ea</b>  |
| 17. <b>#85873</b>   | Waterline Tank or Valve to Bubbler | <b>\$16.37 ea</b>  |
| 18. <b>#85877</b>   | Waterline Inlet to Valve or Tank   | <b>\$22.62 ea</b>  |

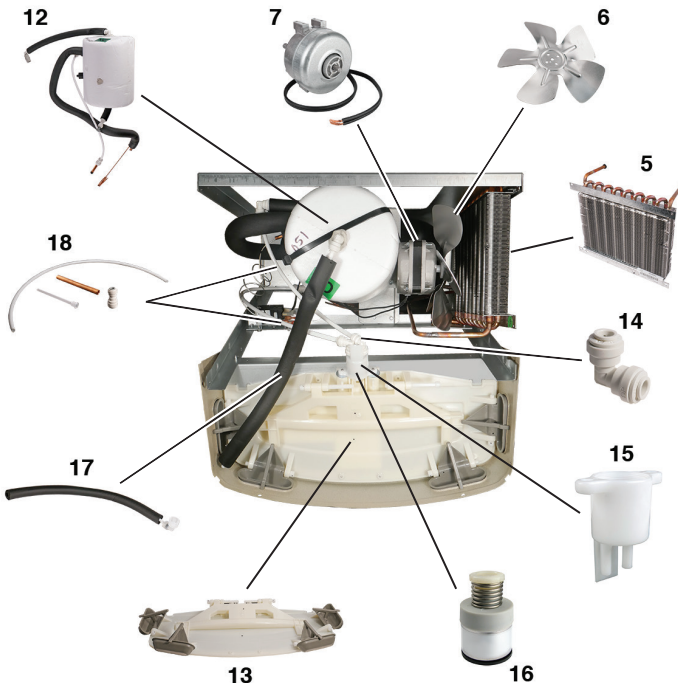

### #03530 (PG8AC) COMPLETE UNIT

**\$572.02 ea**

- 8.0 GPH
- Non-Filtered
- ADA Compliant
- Wall Mount
- Flexible Bubbler
- Powder Coated Sandstone Finish



## SINGLE WATER COOLER AND EZH2O® BOTTLE FILLING STATION

**ELKAY** 

**#03586**

(LZS8WSVRSK)

Vandal-resistant bubbler

**FILTERED**

**\$1537.50 ea**



**#88095**

(LZS8WSSK)

Flexi-Guard® bubbler  
(Shown)

**FILTERED**

**\$1689.25 ea**

- Bottle filler has sanitary, touchless activation, and automatic 20-second shut-off
- Quick Fill Rate: 1.1 GPM
- Laminar flow provides minimal splash
- Visual user interface includes Innovative Green Ticker™ which counts bottles saved from waste
- Stainless steel cooler panel finish

## EZH2O® RETROFIT BOTTLE FILLING STATION

**ELKAY**



**#86394** (EZWSRK)

**NON-FILTERED**

**\$775.60 ea**



- Retrofits to select Elkay **PUSH BAR** drinking fountains
- Auto 20-second shut-off
- Integrated Silver Ion Anti-microbial Protection in key areas
- Quick Fill Rate: 1.1 GPM when connected to refrigerated EZ models, 1.5 GPM for non-refrigerated connections
- Visual user interface includes Innovative Green Ticker™ which counts bottles saved from waste

**FILTERED**

**#83462** (LZWSRK)

**\$805.20 ea**

- Same as above but for FILTERED EZ units

## EZH2O® BOTTLE FILLING STATION WITH SINGLE COOLER

**ELKAY** 

**#03585** (LZS8WSLK)

**FILTERED**

Light Gray Granite Finish

**\$1475.30 ea**



**#86393** (Ezs8WSLK)

**NON-FILTERED**

Light Gray Finish

**\$1363.00 ea**

- Bubbler has easy-to-operate push-bar activation.
- Bottle filler has a sanitary, no-touch sensor activation with automatic 20-second shut-off time.
- Fill rate is 1.1 GPM.
- Cooling capacity: 8 GPH.
- LED filter status indicator showing when filter needs changed
- Green Ticker shows the number of 20oz. plastic water bottles saved from waste.
- Laminar flow provides a clean fill with minimal splash.
- Flexi-Guard Bubbler provides a flexible, antimicrobial mouth guard to protect against injury and microorganisms.
- Silver antimicrobial protection on key plastic components inhibits the growth of mold and mildew.
- The 3000 gallon filter included with the #03585 model is certified to NSF 42 and 53 for lead, Class 1 particulate, chlorine, taste, and odor reduction.

## WALL MOUNT WATER COOLER

**ELKAY** 

**#03557** (Ezs8L)

**NON-FILTERED**

**\$599.99 ea**



- Easy-Touch push bar activation
- Extra deep basin minimizes splashing; with integral drain
- Flexi-Guard® safety bubbler
- Valve with built-in flow regulator to provide constant stream from 20 to 105 psi water pressure

**#03557SS** (Ezs8S)

As above with stainless steel panels

**NON-FILTERED**

**\$649.99 ea**

## PUSH BUTTON BOTTLE FILLER

**OASIS** 

**#86632** (PWSMSBF)

**FILTERED**

**\$593.61 ea**



- Stainless Steel Finish
- Built-in 100 micron strainer stops particles before they enter the waterway
- Waterways are lead-free
- Mechanically activated push button
- Non-Refrigerated. Can be paired with a remote chiller
- ADA Compliant
- Silver-based antimicrobial compound reduces the growth of microorganisms and mildew
- Built-in drain, no drip tray to empty
- No electricity required





## HANDS FREE VERSAFILLER BOTTLE FILLER RETROFIT KIT

### New Style! Stainless Steel Alcove



**#03535NSF**

(PWFEBF 507003)

**FILTERED**

**\$787.35 ea**

**#03535NS**

(PWEBF 507000)

**FILTER-CAPABLE**

**\$714.85 ea**

### Old Style Plastic Alcove



**#03535F** (PWFEBF)

**FILTERED**

**\$787.35 ea**

**#03535** (PWEBF)

**FILTER-CAPABLE**

**\$714.85 ea**



## BARRIER-FREE VERSACOOLER II WITH HANDS-FREE VERSAFILLER

### New Style! Stainless Steel Alcove



**#03542NS**

(PG8EBF 507027)

**FILTER-CAPABLE**

Sandstone Finish

**\$1506.91 ea**

**#03542SSNS**

(PG8EBF-SS 507028)

**FILTER-CAPABLE**

Stainless Steel Finish

**\$1651.91 ea**

### Old Style Plastic Alcove



**#03542**

(PG8EBF)

**FILTER-CAPABLE**

Sandstone Finish

**\$1506.91 ea**

**#03542SS**

(PG8EBF-SS)

**FILTER-CAPABLE**

Stainless Steel Finish

**\$1651.91 ea**

## WALL MOUNTED REFRIGERATED BOTTLE FILLER



Abandon the bubbler for better aesthetics, safe, touch-free operation, and chilled water on demand. More schools, hospitals, and offices are abandoning the bubbler in this post-Covid world.

### Features:

- Matches existing wall rough-in so there's no demo work. Easy to install
- Uses same piping and electrical systems, saving time and money
- Delivers gallons of chilled water on demand, filling a standard sports bottle 6X faster than the bubbler
- Single product can replace multiple makes and models
- Side access to bottle filler makes filter changes quick, clean, and easy
- No tray to collect debris or garbage
- Industry-leading 5-year warranty for added peace of mind



**#49803NS**

(PGN8EBF 507125)

New Style with  
Stainless Steel Alcove

**FILTER-CAPABLE**

**\$1320.22 ea**



**#49803**

(PGN8EBF)

Old Style with  
Plastic Alcove

**FILTER-CAPABLE**

**\$1320.22 ea**

# SLOAN SIDE MOUNT OPERATORS

## SLOAN. SIDE MOUNT OPERATORS

### Battery Powered, Sensor Activated Retrofit Conversion Kits For Exposed Flushometers

- Retrofits to Sloan -Royal, Regal, Crown, and Zurn Flushometers
- ADA compliant infrared side mount sensor for automatic hands-free activation
- Chrome plated housing
- Includes four "C" cell alkaline batteries
- Three year battery life at 3000 flushes/month
- User friendly three second flush delay
- Automatic 72 hour sentinel flush keeps fixture fresh during periods of non-use
- Indicator lights show when user is in range or battery is low
- 3 year limited warranty

#### Sloan TMO Single-Flush Side Mount Retrofit

**#85606** (EBV-500-A)

**\$159.00 ea**



#### #85606CS

Case of 6

**\$950.00 ea**

#### Sloan TMO Dual-Flush Side Mount Retrofit

**#85605** (EBV-550-A)

**\$274.17 ea**



## SIDE MOUNT OPERATOR WITH METAL COVER

SLOAN.



**#08532** (EBV-89-AM)

**\$210.83 ea**

- Fits Sloan or Zurn
- Sensor-operated for hands-free performance
- Low battery light notification
- Courtesy flush button
- Standard "C" batteries supplied
- No water shut-off required for installation or battery replacement
- Fixtures stay cleaner longer
- Helps eliminate odors
- ADA compliant

## SMOOTH SIDE MOUNT OPERATOR

*For Closet or Urinal*

SLOAN.

**#08825** (EBV-200-A) **\$263.80 ea**



**From Manual to Electronic in Less Than a Minute! No Assembly Needed!**

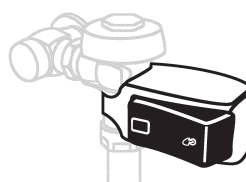
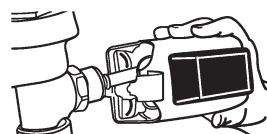

- Battery powered
- Utilizes four "C" batteries
- Installs over existing handle
- Left or right handed installation
- SMOOTH sleeps when the restroom is dark, extending battery life

## SLEEVE ASSEMBLY FOR SINGLE FLUSH SIDE MOUNT

## SLEEVE ASSEMBLY FOR DUAL FLUSH SIDE MOUNT

*Extend the Life of Your Side Mounts!*



SLOAN.



**#88849** (EBV-570-A)

**\$3.38 ea**

**#89753** (EBV-505-A)

**\$3.38 ea**

## SLOAN GEM FLUSH VALVE SIDE MOUNT ADAPTER

SLOAN.

**#SP5524** (EBV-157)

Adapt GEM and Naval valves to fit Sloan Side Mounts  
**#08532, #85605, and #85606.**



**\$18.88 ea**

*Just screw the adapter onto the Gem handle hole, and then install the Side Mount onto the adapter.*



# FLUSH VALVE

21

SLOAN.

## COVERS



**#08049** (A72)  
Chrome Plated Cover  
For Royal

\$24.73 ea



**#08083** (R10)  
Chrome Plated Cover  
For Regal

\$27.50 ea



**#08050** (A71)  
Plastic Inside Cover

\$7.94 ea

SLOAN.

## DIAPHRAGMS



**#08002** (A156A)  
Common

\$4.94 ea



**#08051** (A56A)  
Old Style  
w/ Copper Ring

\$6.37 ea

SLOAN.

## MOLDED DISC



**#08003** (A15A)  
For Regal & Old Style Royal

\$3.84 ea

SLOAN.

## CLOSET RELIEF VALVES



**#08004** (A19AC)  
White Plastic  
(Also used in 3.0 GPF urinals)

\$5.98 ea



**#08052** (A19ACM)  
Old Style Brass

\$14.72 ea



**#08427** (A19AL)  
Blue 2.4 GPF

\$5.98 ea

## URINAL RELIEF VALVES



**#08005** (A19AU)  
Black Plastic

\$4.55 ea

## CLOSET/URINAL RELIEF VALVE



**#08345** (A19ALC)  
Green - Low Consumption

\$4.55 ea

SLOAN.

## VACUUM BREAKER REPAIR KITS



**#08012**  
(V551A)  
Standard

\$2.75 ea



**#08438**  
(V651A)  
New Style Royal

\$3.65 ea

SLOAN.

## GUIDES



**#08006** (A163A)  
Adjustable Guide  
(Standard)

\$9.70 ea



**#08252** (A152A)  
Adjustable Guide  
For 3.5 GPF  
Water Saver Closet Kit

\$9.99 ea



**#08348** (A151A)  
Adjustable Guide  
For 1.6 GPF  
Low Consumption  
Closet

\$18.41 ea



**#08572** (A157)  
Adjustable Guide  
For 0.5 GPF  
Low Consumption Urinal

\$11.34 ea

**#08349** (A155A)  
Adjustable Guide  
For 1.0 GPF  
Low Consumption Urinal

\$18.58 ea

Delany  
Products.

## TRUSTOP WITH TRUCHEK



Key Not Included

**#49833**  
1" Back Check  
Angle Stop

\$98.90 ea

**#49834**  
3/4" Back Check  
Angle Stop

\$98.90 ea

- No need to shut off the water to the bathroom, floor, or building
- Fits any manufacturer's flush valve!
- Revolutionary 1/4 turn ball valve design
- Back check (TruChek) is on the flush valve side instead of the supply side
- Easy to adjust flow

Use your smart phone camera to scan this QR code and watch a short demo video of the game changing TruStop!



## HYDRANT KEY



**#45596**  
Fits 9/32 square. Thin wall fits some lav supply stops.

\$3.49 ea

# DOOR HARDWARE

## SELF ADHESIVE BUMPER PLATE



3/16" Thick

**#10325**

3" Protector Bumper Plate

**\$2.82 ea**

**#10326**

5" Protector Bumper Plate

**\$3.82 ea**

## SOLID BRASS DOOR STOP



**#01168**

Dull Chrome Finish

**\$30.85 ea**

**#01169**

Polished Brass Finish

**\$29.50 ea**

## COAT & HAT HOOK - 3" PROJECTION



Aluminum Material

**#05602**

Brass

**\$1.44 ea**

**#05603**

Dull Chrome

**\$2.16 ea**



Solid Brass Material  
Decorative Finish

**#10297**

Polished Brass

**\$10.40 ea**

**#10298**

Chrome

**\$12.10 ea**

## DOOR SILENCER



**#01164**

1/2" Diameter • 9/16" Projection

**15¢ ea**

## TRACK HANGER HOOK



*Perfect For Hanging Holiday Lights,  
Planters, and Decorations!*

**#11141**

**99¢ ea**

## HINGE DOCTOR

**Fix Sagging Doors in Fifteen Seconds!**

*A Must for  
Every Shop!*



**#36752**

For Standard  
Commercial  
4-1/2" x 4-1/2"  
Butt Hinges

**\$84.50 ea**



**#36754**

For Ball Bearing  
& Larger  
Commercial Hinges

**\$88.20 ea**



**#36755**

For Prison & Institutional  
Hinges and Standard  
Spring Hinges

**\$159.60 ea**

## HINGE DOCTOR KIT

**#36758**

Kit includes all three above Hinge  
Doctors, as well as "The Hulk"  
for most residential hinges.

**\$365.60 ea**



*NEW HEAVY  
DUTY CASE!*

## HINGE REPAIR SCREWS



← *Undercut Head*

← *12/24 M/S Thread*

← *Drill Point*

**#71628**

Pack of 100 pcs.  
Chrome Plated

**\$73.80 pk**

**#71630**

Pack of 100 pcs.  
Black Plated

**\$73.80 pk**

These specially made  
screws have a #12 Phillips  
undercut head with a #14  
oversized body that is self-  
drilling and self-tapping!

**#71628-24**

Pack of 24 pcs.  
Chrome Plated

**\$20.50 pk**

**#71630-24**

Pack of 24 pcs.  
Black Plated

**\$20.50 pk**

## HINGE TAPPING SCREWS



← *Undercut  
#12 Head*

← *Sheet Metal  
Screw Thread*

**#71631**

Box of 100 pcs.  
Chrome Plated

**\$73.80 bx**

**#71629**

Box of 100 pcs.  
Brass Plated

**\$73.80 bx**

**#71632**

Box of 100 pcs.  
Black Plated

**\$73.80 bx**

**#71631-24**

Box of 24 pcs.  
Chrome Plated

**\$20.50 bx**

**#71629-24**

Box of 24 pcs.  
Brass Plated

**\$20.50 bx**

**#71632-24**

Box of 24 pcs.  
Black Plated

**\$20.50 bx**



# GARBAGE DISPOSALS

23

## ADVANCED SERIES - PRO MODELS

### Grind more types of food waste than ever before!

Equipped with up to four stages of Multigrind® Technology designed to prevent clogs by grinding food waste finely.

### The quietest. Unmatched performance

Features up to two levels of SoundSeal® Technology, making them our quietest garbage disposals on the market.

### Garbage disposal installation made easy!

EZ Connect disposals feature the EZ Connect Cord or Hardwire Adapter, Lift & Latch® technology, removable dishwasher inlet plug, and EZ Grip Handles to simplify installation.



## BADGER SERIES - BUDGET MODELS

### Reliable and functional choice when affordability is the prime concern

Space-saving compact design

### Dependable food grind for most food scraps

Rugged construction with heavy duty Dura-Drive® for long-lasting performance



#### PRO 1250

#20268  
With Cord

**\$625.30 ea**

#20269  
Without Cord

**\$621.50 ea**



#### PRO 1000

#20270  
With Cord

**\$519.70 ea**

#20271  
Without Cord

**\$514.20 ea**



#### PRO COVER CONTROL

#20272  
With Cord

**\$476.80 ea**

#20273  
Without Cord

**\$469.40 ea**



#### BADGER 5XP

#20267  
With Cord

**\$258.85 ea**

#85961  
Without Cord

**\$252.48 ea**



#### BADGER 5

#57721  
With Cord

**\$218.96 ea**

#20266  
Without Cord

**\$198.20 ea**

MultiGrind	Four Grind Stages	Four Grind Stages	Three Grind Stages	No	No
SoundSeal®	Yes	Yes	Yes	No	No
Activation	Wall switch	Wall switch	Magnetic Cover Control	Wall switch	Wall switch
Horsepower	1.25 H.P. Motor	1.0 H.P. Motor	3/4 H.P. Motor	3/4 H.P. Motor	1/2 H.P. Motor
Feed Type	Continuous	Continuous	Batch	Continuous	Continuous
Stainless Steel Grinding Elements	Yes	Yes	Yes	No	No
Antimicrobial Quiet Collar Sink Baffle	Yes	Yes	Yes	No	No
Lift & Latch®	Yes	Yes	Yes	Yes	Yes
EZ Connect Disposal	Yes	Yes	Yes	No	No
Warranty	12 Year In-Home	11 Year In-Home	10 Year In-Home	4 Year In-Home	3 Year In-Home

# T & S FAUCETS



## Pick Your Body!



### 4" DECK MOUNT FAUCET

**#02386**

*Less spout*

**\$113.20 ea**



### 8" BACK MOUNT FAUCET

**#SP6908**

*Less spout*

**\$181.64 ea**

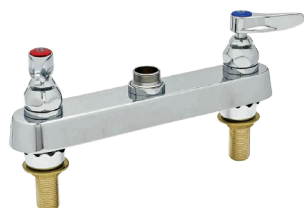

### 8" DECK MOUNT FAUCET

**#66876**

*Less spout*

**\$167.18 ea**



### SWIVEL/RIGID PRE-RINSE FAUCET BASE

**#55002**

*Less spout*

**\$214.36 ea**



### SINGLE HOLE SINGLE TEMPERATURE DECK MOUNT FAUCET BODY

**#69043**

*Less spout*

**\$127.96 ea**



## Pick Your Spout!

### SWING SPOUTS

*Nozzle has male threads with stream regulator*

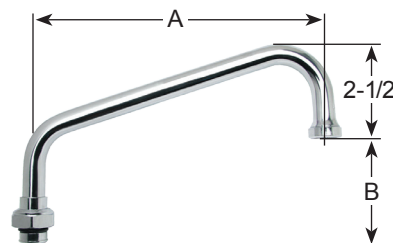

PART#	A	B	PRICE	PART#	A	B	PRICE
#44914	6"	2"	<b>\$34.34 ea</b>	#02288	14"	4-1/4"	<b>\$44.01 ea</b>
#02285	8"	2-1/4"	<b>\$36.58 ea</b>	#44910	16"	5"	<b>\$46.47 ea</b>
#44915	10"	3"	<b>\$39.09 ea</b>	#44911	18"	5-3/4"	<b>\$49.15 ea</b>
#44909	12"	3-3/4"	<b>\$41.47 ea</b>				

### SWIVEL GOOSENECK

*Nozzle has male threads with stream regulator*

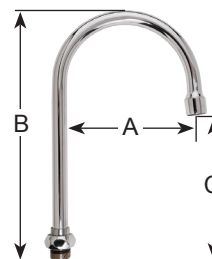

PART#	A	B	C	PRICE
#02300	2-3/4"	4-1/2"	2-3/8"	<b>\$47.48 ea</b>
#02301	2-3/4"	8-3/4"	5-1/8"	<b>\$49.15 ea</b>
#02302	5-3/4"	8-3/4"	4-3/4"	<b>\$47.78 ea</b>
#02303	8-3/4"	11-3/4"	5-1/8"	<b>\$63.97 ea</b>
#83555	12-1/4"	14-11/16"	5-3/8"	<b>\$126.56 ea</b>

### DOUBLE JOINTED SWING SPOUTS

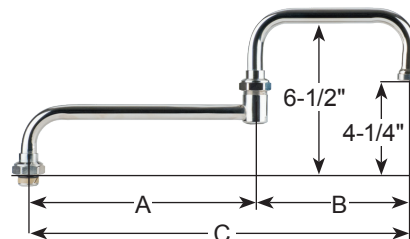

PART#	A	B	C	PRICE
#02291	6"	6"	12"	<b>\$163.07 ea</b>
#02292	9"	6"	15"	<b>\$123.57 ea</b>
#02293	12"	6"	18"	<b>\$101.17 ea</b>
#02294	12"	12"	24"	<b>\$109.90 ea</b>





## LAKECREST METERING LAV FAUCET

NEW!



#20053 (BP-0723)

\$130.74 ea

- Single hole, single temperature
- Polished chrome finish
- Deck mounted
- 0.5 GPM concealed, vandal-resistant, non-aerated spray device



## LAKECREST SINGLE LEVER FAUCET

NEW!



#20054 (BP-2704)

\$282.40 ea

- Single hole
- Polished chrome finish
- Deck mounted
- Ceramic cartridge
- 0.5 GPM concealed, vandal-resistant, non-aerated spray device



## LAKECREST SINGLE LEVER FAUCET

NEW!



#20055 (BP-2712)

\$330.68 ea

- 4" centerset
- Polished chrome finish
- Deck mounted
- Ceramic cartridge
- 0.5 GPM concealed, vandal-resistant, non-aerated spray device



## LAKECREST 8" WIDESPREAD FAUCET

NEW!



#20056 (BP-2995)

\$261.16 ea

- 8" centerset
- Polished chrome finish
- Deck mounted
- Ceramic cartridges
- 0.5 GPM concealed, vandal-resistant, non-aerated spray device

## PRE-RINSE UNIT SINGLE HOLE DECK MOUNT

#02001 (B-0113)  
24" Riser



\$484.62 ea

## PRE-RINSE UNIT WALL MOUNT

#02024 (B-0133)  
8" Centers  
18" Riser



\$536.45 ea



## ADD-ON FAUCET



Fits  
3/8" IPS

#02002  
With 6" Nozzle

\$129.01 ea

#02003  
With 12" Nozzle

\$138.24 ea

#02004  
With 18" Nozzle

\$144.77 ea



## COMPLETE MINI PRE-RINSE UNIT SINGLE HOLE WITH ADD-A-FAUCET



#83575 (MPZ2DLN06)  
24.5" High

\$637.07 ea

# CHEMICALS

## JAVELIN URINAL TREATMENT - 32 oz.

**#90094** **\$25.25 ea**



- Quickly breaks down hard, uric salt deposits, and maintains urinal drain flow.
- Clings to the pipe and urinal bowl, leaving behind a protective, non-stick coating which prevents future deposits from forming
- Eliminates the need for urinal removal and mechanical drain opening, saving labor cost and time
- Eliminates foul odors

## STREAK-PROOF GLASS CLEANER - 20 oz.

**#79765** **\$5.63 ea**



- Spray on and wipe dry
- Non-streaking
- Cleans, restores, and shines
- Leaves no film
- Fast drying

## JAVELIN™ TUB & SINK TREATMENT 32 oz.

**#90122** **\$25.25 ea**



- Heavier than any liquid alkaline drain opener
- Bores right through standing water to the clog
- Twice as strong as any alkaline drain opener
- Compatible with PVC, cast iron, copper and ABS lines, rubber seals, porcelain, & is safe for use in grease traps & septic systems.
- Fresh lemon scent
- Deodorizes as it cleans, unlike acid-based openers.

## STAINLESS STEEL POLISH - 20 oz.

**#79766** **\$13.49 ea**



Water-based cleaner/polish formulated for stainless steel, chrome, brass, copper, and aluminum. Removes smudges, fingerprints, water marks, grease, tarnish, and oxidation from bright metals. Seals and protects against future oxidation. Repels dust.

## LENS CLEANING TOWELETTES

**#61919** **\$17.95 bx**



**100  
packets  
per box**

- For polycarbonate, plastic, and glass lenses.
- Anti-static, anti-fog formula.
- Ideal for glasses, goggles, and face shields
- Safe and effective for all types of lens coatings

## JAVELIN™ KITCHEN DRAIN AND SEPTIC TREATMENT 1 Gallon

**#90123** **\$96.80 ea**



- Packed with waste-eating bacteria, containing 150,000,000 per milliliter, making it the strongest biological maintainer available today
- They consume and break down meat proteins, vegetable matter, greases, fats and organic matter
- Completely Safe: certified to be non-pathogenic (won't cause disease) and salmonella-free
- Works with or without oxygen present in the water
- Also works in garbage disposals

## BLUE COTTON EQUI-RAGS

**#36149** **\$26.57 bg**



**Super Absorbent!**  
**A Must For Every Shop!**

## 'WORKING HANDS' HAND CREAM

**#37014** **\$8.97 ea**



- Hydrates the skin with water & glycerin
- Unique formula traps moisture
- Ideal for people who work with their hands everyday
- Also works on feet!



# TUB O' TOWELS

27

## HEAVY DUTY CLEANING WIPES

**#39345**

90 count

**\$18.25 ea**



- Size: 10" x 12"
- 100% solution soaked
- Contains no harsh chemicals
- Durable fiber weave wicks up moisture, enhances scrubbing, and grabs dirt
- Vaporlock™ canister is made of heavy-gauge plastic with locking lid to minimize solution evaporation
- Gentle on hands. Wipes contain aloe, vitamin E and lanolin to leave hands clean and soft
- Pleasant citrus fragrance

## 40 COUNT GRANITE & MARBLE WIPES

**#39348**

40 count

**\$8.75 ea**



- Size: 7" x 8"
- Non-abrasive wipe cleans and protects granite, marble, and other sealed stone surfaces
- Easily removes surface soil, grime, dirt, oil, and water stains
- Polishes surface, leaving a streak-free shine

## STAINLESS STEEL WIPES

**#39346**

40 count

**\$8.75 ea**



- Size: 7" x 8"
- Unique oil-based formula leaves a brilliant, streak-free shine
- Cleans, polishes, and protects against fingerprints, food stains, and streaking
- Non-abrasive cleaning wipe for use on all stainless steel surfaces

## CARPET & UPHOLSTERY WIPES

**#39347**

40 count

**\$8.75 ea**



- Size: 7" x 8"
- Removes tough stains through a blend of cleaners specifically engineered to clean carpet and upholstery
- Durable design allows for vigorous scrubbing on multiple surfaces
- The cleaning solution attacks the soils embedded in close-knit fibers
- Removes pet stains, food stains, grass stains, grease, beverages, paint, cosmetics, ink, and more

# BLUE MONSTER

## BLUE MONSTER® DRY INDUSTRIAL TOWELS

**#90092**

220 count

**\$26.04 ea**



- Size: 9" x 12"
- Great for cleaning up water, solvent and oil-based spills, as well as grease, oil, dirt, grime, and chemicals
- Ideal for parts, tools and surface cleaning, and a range of hard surfaces

## BLUE MONSTER® CITRUS SCRUBBING TOWELS

**#37970**

75 count

**\$25.82 ea**



- Size: 10" x 12"
- Quickly removes grease, oils, inks, lubricants, caulk, pipe dope, cements, flux, tar, and more from hands
- No harsh solvents and chemicals
- Requires no water
- Pleasant citrus scent

**EQUIPARTS**  
Repair Parts Specialists®

**SINCE 1968**

- Expert Knowledge
- Technical Support
- Large Inventory

Click here to see our full catalog of hard to find repair parts and fixtures!



### "POWERGRAB" INSULATED GLOVES

*Allows for precision handling while keeping your hands warm!*



Black		Yellow	
#37834S	SM	#37833S	SM
#37834M	MED	#37833M	MED
#37834L	LG	#37833L	LG
#37834XL	XL	#37833XL	XL
#37834XXL	XXL	#37833XXL	XXL

**\$14.50 pr**

**\$11.99 pr**

### SPIKELESS INDOOR/OUTDOOR TRACTION AIDS

These Spikeless Traction Aids are designed for workers who frequently transition from outdoor to indoor surfaces. The non-spiked design is non-marring, and will provide extra grip in numerous working environments.



**#39597**

Small/Medium  
Fits shoe sizes 4 - 10

**#39598**

Large / Extra Large  
Fits shoe sizes 10.5 - 13

**Your Choice: \$43.82 pr**

### INSULATED DRIVERS GLOVES



- Premium cow grain
- 3M insulate lining traps heat
- High quality, dexterity, and abrasion resistance

**Your Choice!**

**\$15.72 pr**

#61905M	Medium
#61905L	Large
#61905XL	XL
#61905XXL	XXL

### ICE CLEATS

The K1 Series Mid-Sole ice cleat is the one-size-fits-all winter traction solution. The ice-penetrating tungsten carbide spikes maximize grip while the rotatable design provides seamless transition when traction is not required.



**#39596**

One Size Fits All

**\$33.42 pr**

### ORANGE INSULATED PVC GLOVES



**#36538E**

**\$9.89 pr**

- 3-layer insulation keeps hands warm and dry
- Resistant to oils, acids, chemicals, and caustics.

### HAND WARMERS - 10 PAIR



**#39595**

**\$8.80 pk**

Single-use, air-activated heat packs that provide up to 10 hours of continuous warmth for the hands. Pack of 10 pairs.

**TOLL FREE: 800-442-6622 • PITTSBURGH: 412-781-9100 • www.equiparts.com**